

Cape Woolamai Holiday Houses

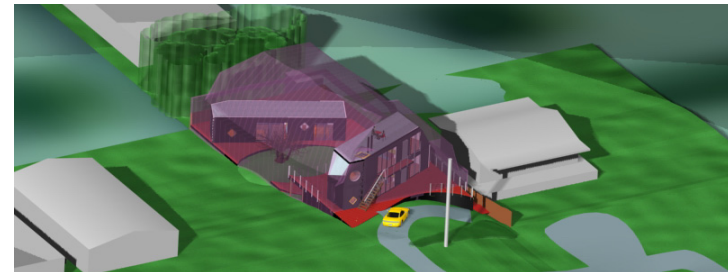

Phillip Island, Victoria
\$240k, 2006

This affordable budget project challenges the accepted norm in suburban housing - the single house as a large mass in the middle of a site with three-six bedrooms plus a master bedroom. By breaking the house into three separate units, each with one 'master' bedroom and a large flexible living/second bedroom space, the house is distributed across the site, leaving a protected courtyard in the middle and giving all rooms excellent cross ventilation and aspect. Each unit has its own separate entry sequence and the second level is accessed by an external stair.

The design both pushes the limits of the ResCode guidelines by breaking the house into three, and pushes itself against the volumetric guidelines, embracing the maximum permissible envelope as a part of the form making process. A parametric study model was used which utilised 3D, 4D (3D plus time), as well as alternate options/realities. The design is 'tuned' to optimise daylight access, views, minimal span floor areas and architectural formal aspirations by adjusting the parameters with real time feedback. The 3D model information was linked back to plans which were used to check suitability of different living scenarios. This innovative built study into flexible and affordable housing was presented at the 2006 *reHousing* conference, and published in *Architecture Australia*.